

# Telescopic Scissor Hoist TS26 & TS32 Frame Assembly

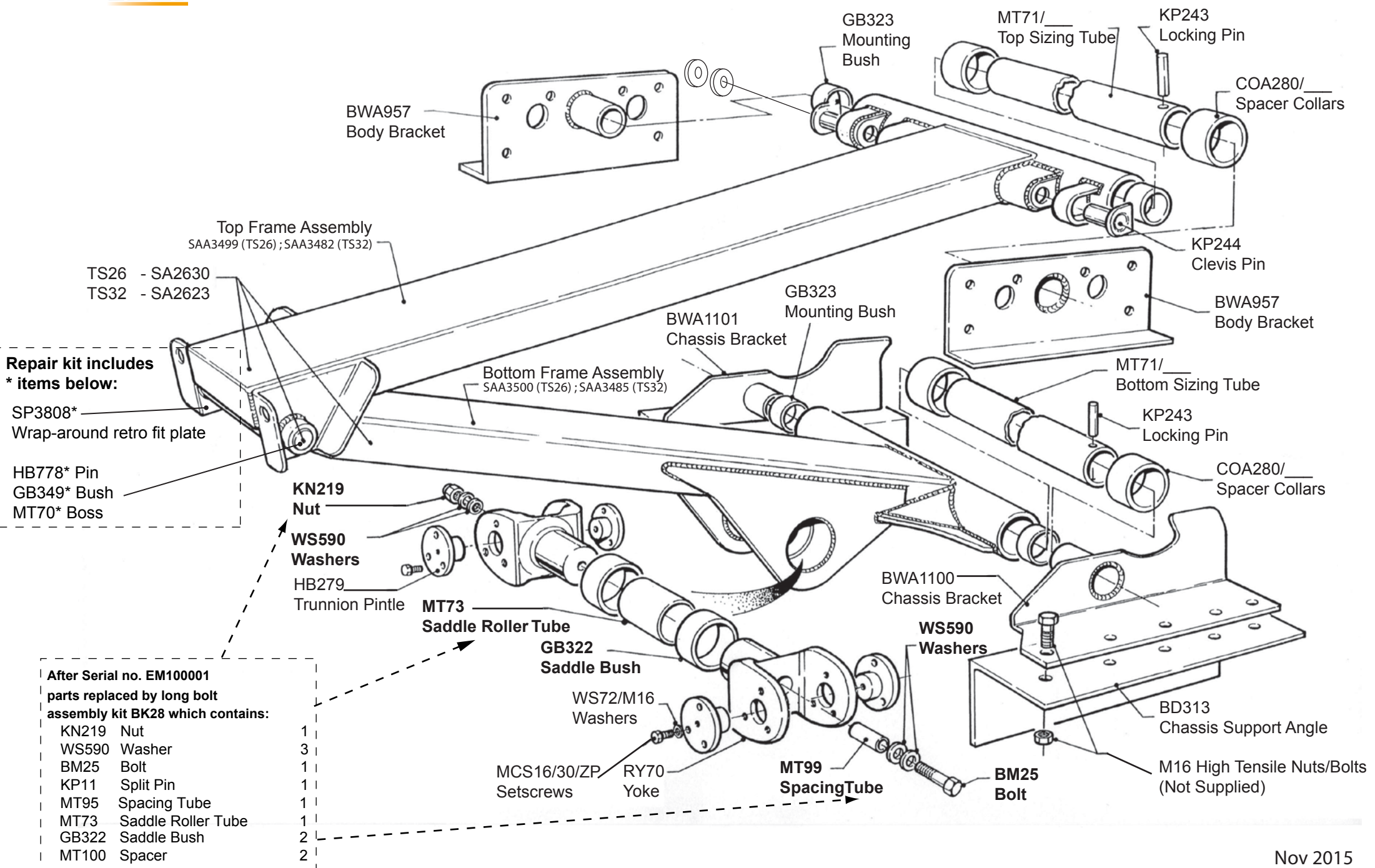

**Repair kit includes  
\* items below:**

- SP3808\*  
Wrap-around retro fit plate
- HB778\* Pin
- GB349\* Bush
- MT70\* Boss

**After Serial no. EM100001  
parts replaced by long bolt  
assembly kit BK28 which contains:**

KN219	Nut	1
WS590	Washer	3
BM25	Bolt	1
KP11	Split Pin	1
MT95	Spacing Tube	1
MT73	Saddle Roller Tube	1
GB322	Saddle Bush	2
MT100	Spacer	2